

 **family focus guide**
February-April 2015
**Masterpieces of
Japanese Art**

cincinnati art museum
we bring people and art together

Welcome to the Cincinnati Art Museum. This guide will explore the incredible collection of Japanese Art at the Cincinnati Art Museum. When you finish this guide, stop by the Front Desk to choose a small prize.

**Before spending time with the art, do you know your...
museum manners?**

Scavenger hunt inside!



Many of the artworks in our collection have been around for hundreds (or even thousands) of years! Help us to keep them safe for 1,000 more by not touching. We recommend **staying an arm's length (or 3 feet) away** from all paintings and sculptures.

The owner of this arm has quite a few of them in gallery 102.

The Art Museum is a big place with lots of art to explore. Remember to **use your walking feet** as you move through the galleries. And remember to stay together with your grown-ups—you have the map, and we don't want them to get lost!



These fancy feet belong to a man in gallery 210.



Remember that we can **only use pencils in the galleries**—no markers, pens, or quills allowed. We also ask you to remember that it's not safe to use the gallery walls or cases as writing surfaces. Instead, borrow a clipboard at the Visitor Services Desk.

Uh oh! Someone brought a quill pen into gallery 202!

If you get lost or have any questions about the Art Museum, there are **friendly guards** stationed throughout the galleries. Say hello, and don't be afraid to ask them for help if you need it.



If you see a friendly guard, why not thank them for keeping the art so safe!



Even though having fun at the Art Museum can make you hungry and thirsty, **we can't have any food or drinks in the galleries**. Visit the Terrace Café if you need a snack break.

Feast your eyes on this beautiful painting in Gallery 110.

cincinnati art museum
we bring people and art together

Most of our artworks love to have their photos taken, but some don't like to be photographed at all.

If you see this symbol:  **please don't take any pictures.**



For this guide, we'd like you to begin on the second floor. **Remember that there are no wrong answers!**

Gallery 234

Find the hanging scroll that shows the legend of **Amaterasu**, the Shinto sun goddess. In the story Amaterasu has been hiding in a cave and this painting depicts the moment she peeks her head out of the cave. What can you see that shows she is the sun goddess?

Gallery 222

Visit *Modern Voices in Japanese Ceramics and Prints* and find the print **Light and Red** by Yoshida Toshi. It will be near a ceramic piece called **Sumi nagashi tsubo [Vessel with Dripping Black Ink Designs]** by Kondō Yutaka. Look at both of these pieces. What do they have in common?

2ND FLOOR

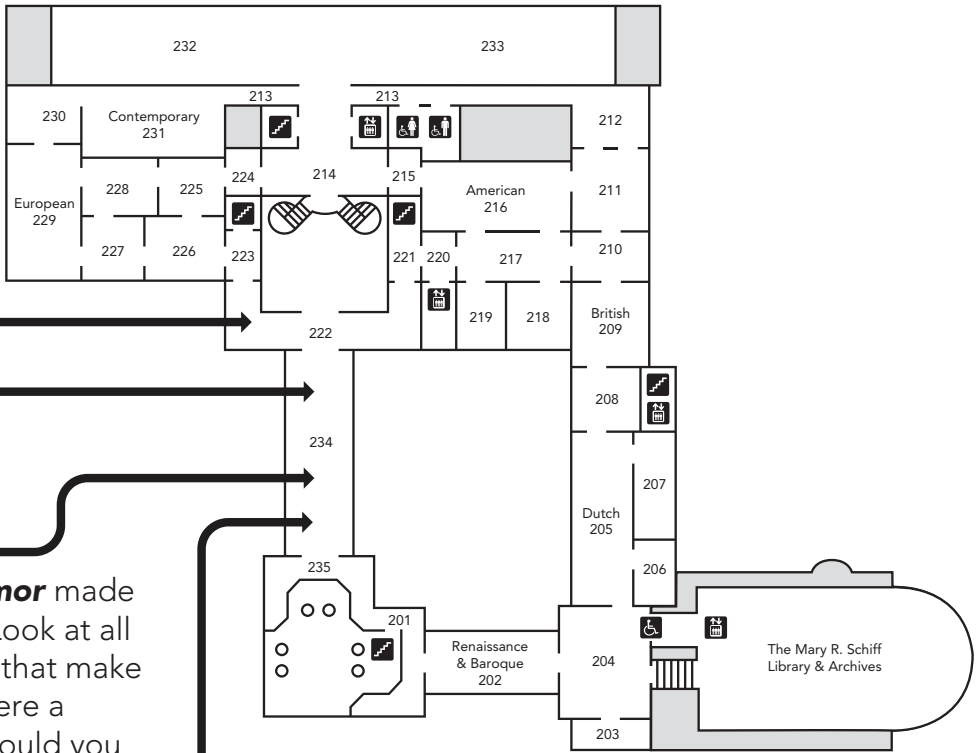

Gallery 234

Locate the **Suit of Armor** made for a samurai warrior. Look at all of the different pieces that make up this armor. If you were a samurai which piece would you put on first?

Which would you put on last?

Gallery 234

The cute **Doll with Accessories** in this room is known as Miss Okinawa. She was a part of a doll-exchange program between the United States that was meant to create friendship between the two countries. Her clothes and accesories were meant to represent the region of Okinawa in Japan. If a doll represented Cincinnati today, what would she be wearing or what would her accessories be?

Gallery 114

Cincinnati's famous Rookwood Pottery Company was founded by Maria Longworth Nichols Storer who was strongly influenced by Japanese art. Find her large **Aladdin Vase** in the middle of the room. What do you see that reminds you of Japanese art?

1ST FLOOR

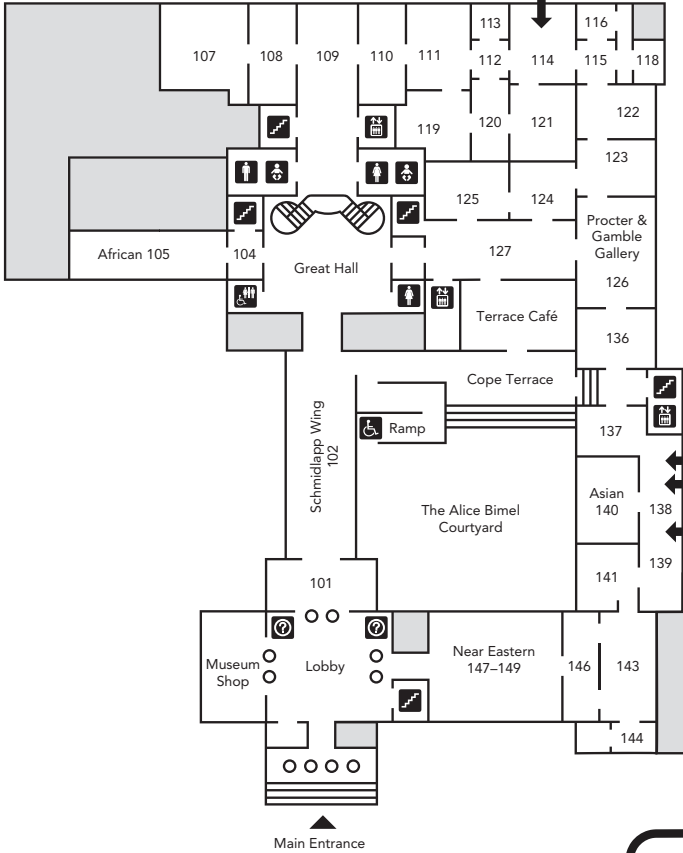

Gallery 138

Japan is famous for tea and for their tea ceremonies. In this room you'll find many teapots. If you were having friends over for tea, which teapot would you like to use? Why do you like this tea pot the best?

Gallery 138

At one end of this gallery hangs a beautifully decorated Japanese **Kimono**. Imagine that you were the designer. How would you have decorated the kimono? Draw your design below:

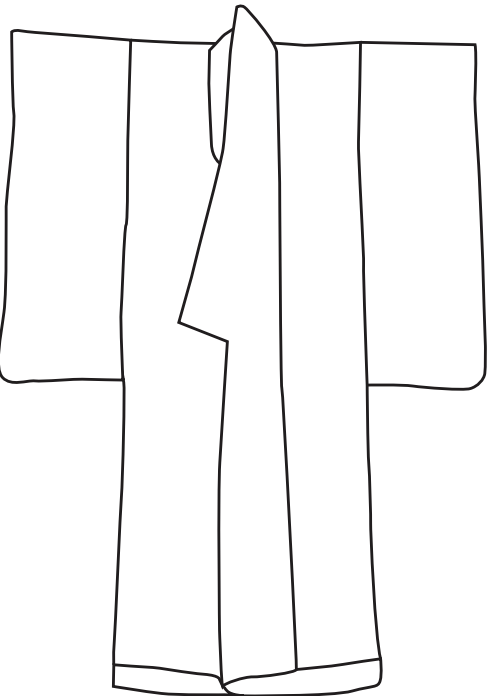

Gallery 138

The **three masks** on display in this room were used in the classic Japanese Nō theater style. Actors would wear these masks to become the different character types they represent. Imagine that you are wearing each mask and strike a pose that shows you are the old man, the cheerful woman, and the ghost.

If you'd like, have someone take a picture of these poses and post them to social media. Be sure to hashtag them **#cincyartmuseum**.